

# A partnership response to raising skills

---

## *Improvement & Responsiveness for our Employers*

Russell Strutt

Principal & CEO

Central Sussex College

Frances Wadsworth

Principal & CEO

East Surrey College

# Two Colleges – the same priority

---

## East Surrey College:

*Providing inspirational, high quality education and training which meets the needs of employers and our local community.*

## Central Sussex College:

*Our mission is to be the college of choice by putting skills and learning at the heart of everything we do.*

# College Culture :

## Employer Engagement a core activity

- ⚡ CSC & ESC - Strong leadership of Employer Engagement activities
  - Augmented profile & staffing of Employer Services function
  - Prioritising & Resourcing employer/college communication
- ⚡ CSC & ESC - Action for Business Colleges
- ⚡ CSC & ESC - Agreed partnership working



# Meeting Employers Needs

---

- ⚡ Wide range of accreditation services & customised courses to meet employer needs
- ⚡ Employer input into most employer-focused courses
- ⚡ Train to Gain at, or ahead of, profile for both Colleges
- ⚡ Short courses and workplace delivery
- ⚡ Training provision re-shaped to provide a flexible vocational offer-online learning materials to common platform under development.

# CSC and ESC- Working in partnership for our future

## Networks and Partnerships:

FE Sussex

T2G - Surrey & Sussex Consortia

A4B Colleges

Private Providers

Employers

✦ ESC & CSC partnership:  
The Gatwick Diamond Skills Academy

✦ ESC/CSC  
Employer networks and contacts  
New builds – world class resources & flexibility

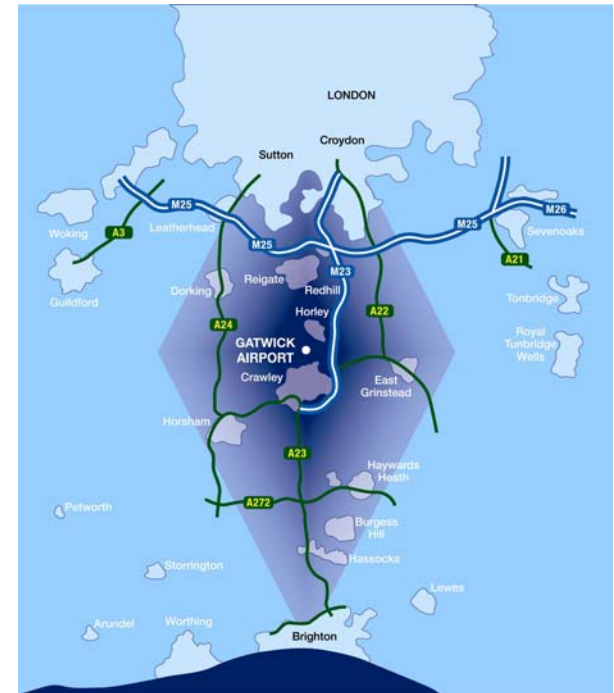



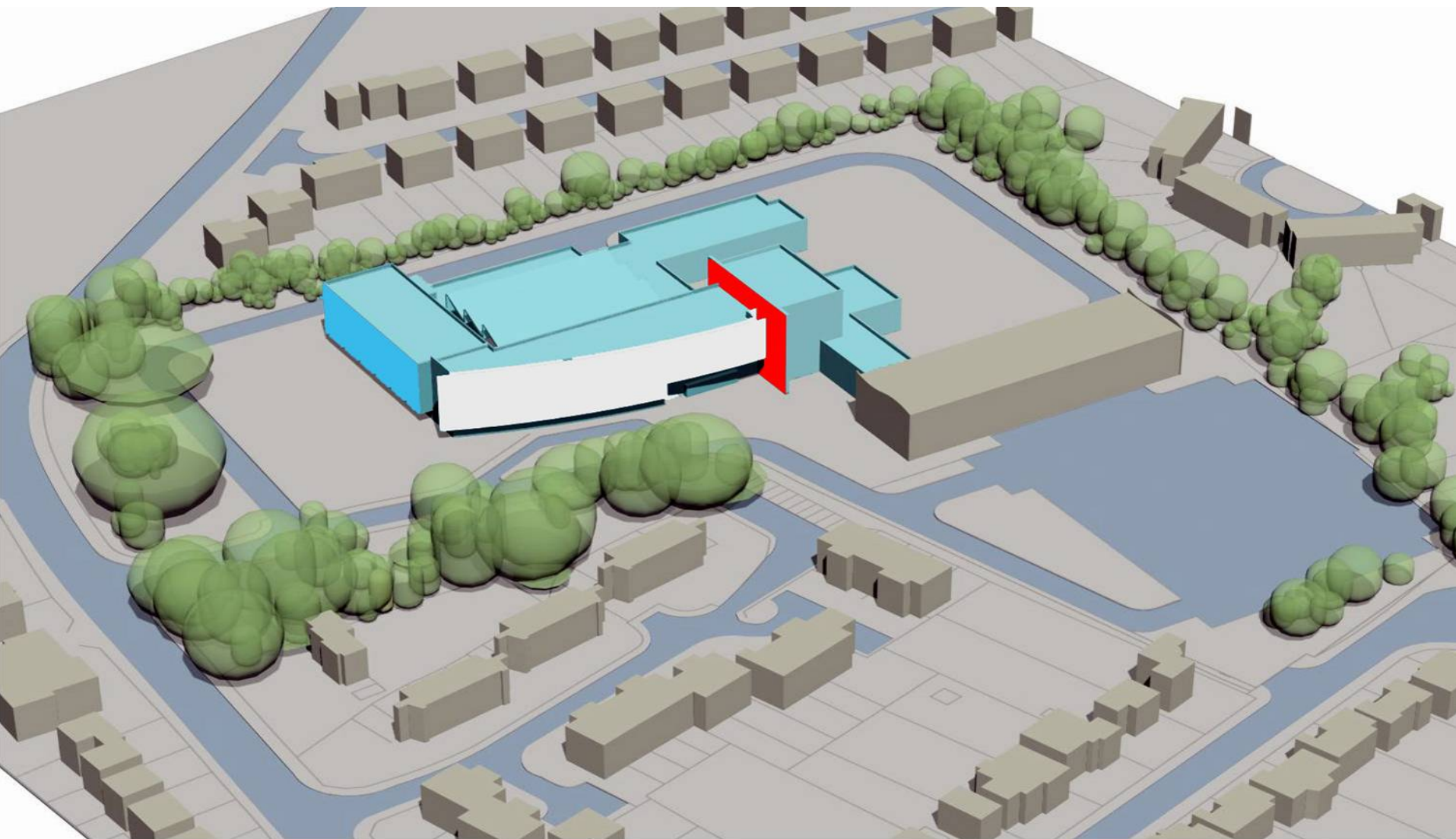

# CSC & ESC: A Shared Vision

---

“Working together the colleges aim to develop a coherent pathway to training, developing a ‘skills escalator’ that engages individuals at entry level, provides progression routes and local access to higher-level qualifications and increases the output of individuals with higher-level skills within the area, matched to the needs of key sectors.

Contained within this vision is the concept of a jointly developed Gatwick Diamond Skills Academy”.

# CSC and ESC: Moving into the future

---

- ⚡ Sector specific approach for the 7 key sectors
- ⚡ Address the mismatch between skills demand and skills supply
- ⚡ Build capacity to increase volumes of skills supply and skills training in key sectors

# Skills supply & training requirements of the key sectors

- ⚡ Key sectors account for 17,100 businesses (52%) and 161,700 employees (52%)
- ⚡ 12,790 new entrants required p.a. by key sectors
- ⚡ 5000-6000 expected from education and training
- ⚡ 1 in 5 employers (5,600 businesses) experience skills gaps

# Skills demand and supply mismatch

- ⚡ Key sectors represent 57% of skills supply demand but only 40% of major vocational training in the colleges
- ⚡ Financial Services/Retail/Hotel & Leisure/Transport & Supporting Services have the major mismatches
- ⚡ CSC/ESC currently deliver training to around 2,000 businesses and around 16,000 employees in the key sectors
- ⚡ CSC/ESC currently have CoVE\* status in Automation and Control Eng, Heritage and Restoration Eng, Retail, Construction and Care

\*Centre of Vocational Excellence

# Sector-specific approach

## East Surrey College

Proposed to lead on:

- Financial Services
- Leadership & Management

## Central Sussex College

Proposed to lead on:

- Retail
- Hotel & Leisure
- Transport & Logistics

- ✦ Capacity building and volume increases will take place at both colleges
- ✦ The sector lead drives and co-ordinates the development in that sector on behalf of both colleges

# Moving into the future: Employers will have:

- ⚡ A single, unified Gatwick Diamond skills escalator offer
- ⚡ Skills centres/academies for each sector
- ⚡ University centre/s
- ⚡ Access at 9 locations
- ⚡ Access online through a virtual learning environment and learndirect

